

User Manual(SP-Series)

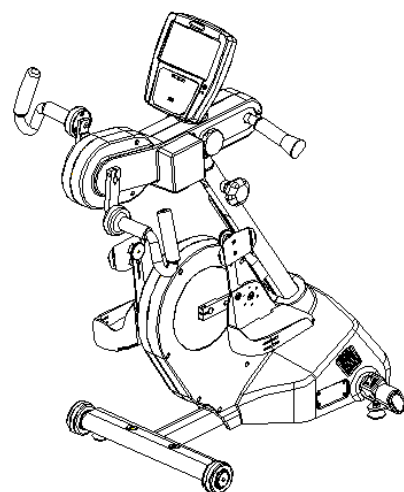

LET'S DO IT, REHABILITATION

BOJONGmc

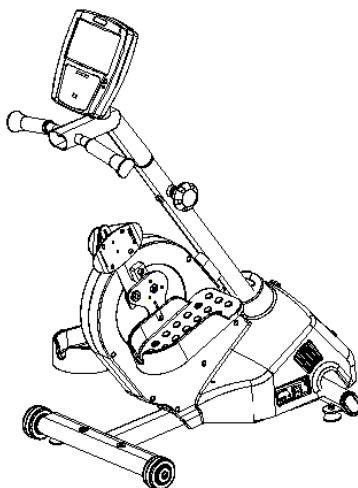
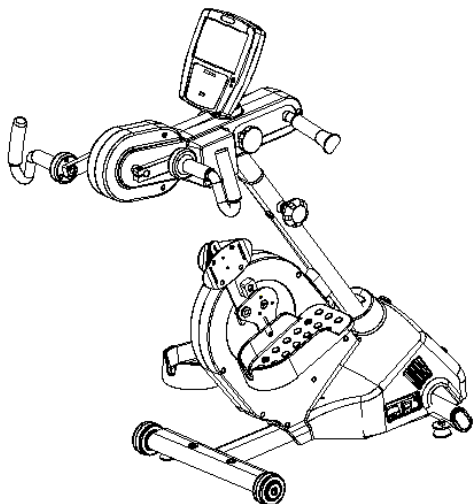

BojongMC Co., Ltd

1dong, 83, Hyeomnyeok-ro, Siheung-si, Gyeonggi-do,
15095, Korea

Tel : +82-32-672-1381

Fax : +82-32-672-1382

E-Mail : inform@bojongmc.co.kr

Home page : www.bojongmc.co.kr

EU Representative

Obelis s.a

Boulevard General Wahis, 53 1030 Brussels Belgium

Tel: +32 2 732 59 54

E-Mail : mail@obelis.net

Home page : www.obelis.net

Table of Contents

1. Important Safety and Information -----	3
2. Intended Use, Product Introduction -----	4
2.1 Product and Model	
2.2 Intended Use	
2.3 Introduction	
2.4 Product Features	
3. Name of Components and Installation -----	8
3.1 Name of Components	
3.2 Installation	
3.3 Instructions for Using	
4. Monitor -----	12
5. Spasm Control -----	14
6. How To Use -----	15
6.1 Upper Limbs Exercise	
6.2 Lower Limbs Exercise	
6.3 Adjusting height with Upper Body	
7. PCB Monitor Setting Method(LCD Touch-screen monitor) -----	17
7.1 P Mode: Passive Mode	
7.2 Program Setting Mode	
7.3 A Mode: Active Mode	
7.4 TV Mode	
7.5 Exercise Results	
8. PCB Monitor Setting Method(Segment Monitor)-----	24
9. Device Maintenance-----	26
10. Storage and Moving-----	27
11. Product Guarantee-----	27
12. Breakdown and Diagnosis-----	28
13. Product Identification-----	28
14. Symbol Explanation -----	29

1. Important Safety and Information

Please read this manual carefully from beginning to end before using the equipment for the first time.

This exercise equipment is designed and built for optimum safety. However, certain precautions are applied whenever you operate a set of exercise equipment. Make sure to read the entire manual before assembling and operating this machine. Also, please note the following safety precautions:

 This symbols used in this instruction manual and, if applicable, on the exerciser are intended to point out potential dangers when using the exerciser.

WARNING: If you do not follow these precautions, it may cause death or serious injury.

CAUTION: If you do not follow these precautions, it may cause serious injury.



WARNING

1. To avoid risk of electric shock, this equipment must only be connected to a supply mains with protective earth.
2. Do not modify this equipment without authorization of the manufacturer.
3. Professional use only under a close supervision by a clinical staff.
4. Patients must not use without being supervised by an assistant.
5. Leave standing at least one hour at room temperature after transporting or before first use.
6. Always place on a level and non-slip surface so as to ensure maximum stability.
7. Always wear snug fitting clothing when using the exerciser.
8. Designed to be used in a sitting position only.
9. Operate the equipment correctly in order to utilize the most functions of the equipment.
10. Close supervision is necessary when used by, with, or near children, invalids, or physically challenged persons.
11. Do not position the equipment to make it difficult to operate the disconnection device (Appliance coupler or separable plug).



CAUTION

1. If using a wheelchair with the exerciser, please engage the wheelchair's brake and secure its stability before exercising.
2. The crank length must not be adjusted when the motor is running.
3. Never reach into, or attempt to take hold of, moving parts of the exerciser when it is running.
4. Never use the exerciser with a damaged power cord. Use only the original power cord supplied with the exerciser.
5. Use the rated voltage.
6. To prevent electric shock, never use in wet, damp, or very hot conditions.
7. If the exerciser is damaged/faulty or if it produces abnormal noises or smells, stop the exercising session immediately, unplug the power cord, and contact your service engineer.
8. This product may malfunction due to the electromagnetic waves caused by cell phones, transceivers, radio-controlled toys, etc., be sure to avoid having objects such as, which affect this product brought near product.
9. Interconnected equipment to this equipment shall be complied with the appliance international standards, e.g. IEC/EN 60950-1 for I.T. equipment.

2. Intended Use, Product Introduction

2.1 Product and Model

1.1 Product: Physiotherapy Apparatus for Upper and Lower Limbs

1.2 Model & Specification

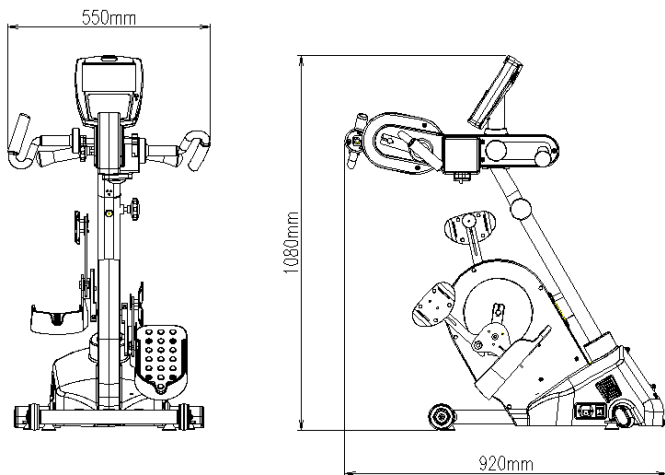

SP-1100 Size : (W) 550mm X (D) 920mm X (H) 1080mm
Weight : 40kg
Use Upper Limbs, or Lower Limbs

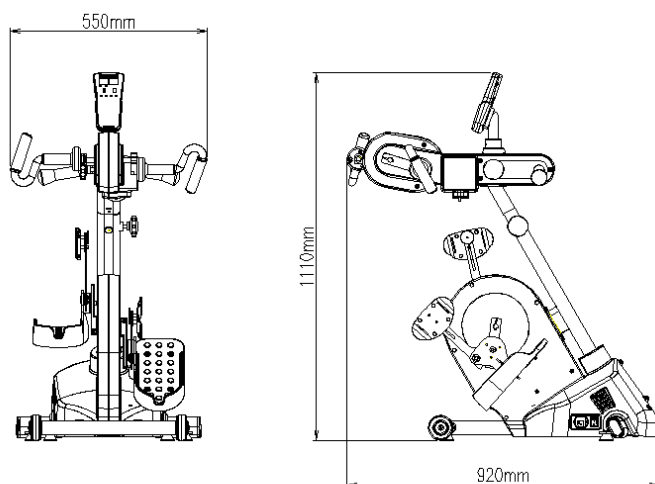

SP-1100E Size : (W) 550mm X (D) 920mm X (H) 1110mm
Weight : 40kg
Use Upper Limbs, or Lower Limbs

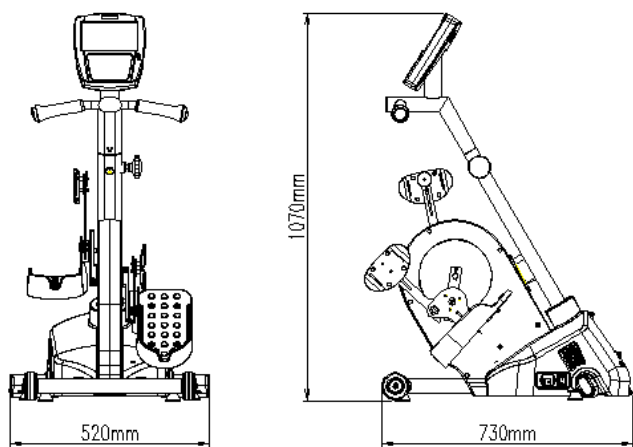

SP-2100 Size : (W) 520mm X (D) 730mm X (H) 1070mm
Weight : 33kg
Use Only Lower Limbs

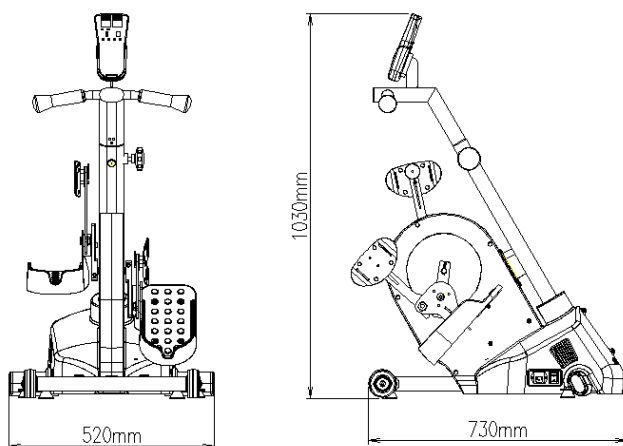

SP-2100E Size : (W) 520mm X (D) 730mm X (H) 1030mm
Weight : 33kg
Use Only Lower Limbs

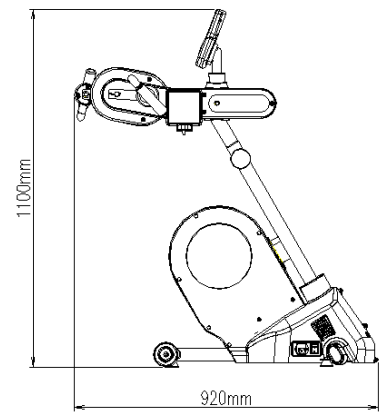
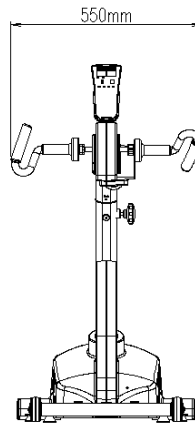
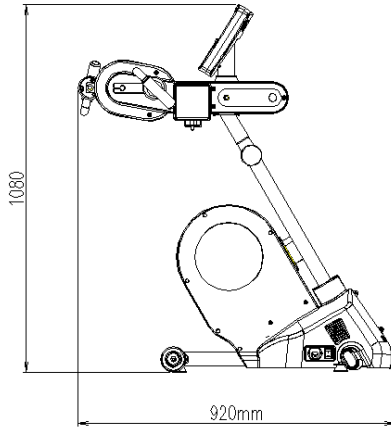
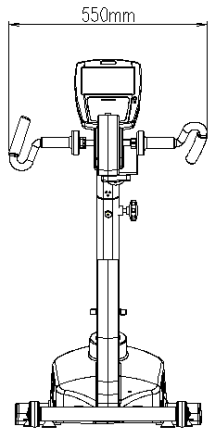

SP-3100 Size : (W) 550mm X (D) 920mm X (H) 1080mm
 Weight : 32kg
 Use Only Upper Limbs

SP-3100E Size : (W) 550mm X (D) 920mm X (H) 1100mm
 Weight : 32kg
 Use Only Upper Limbs

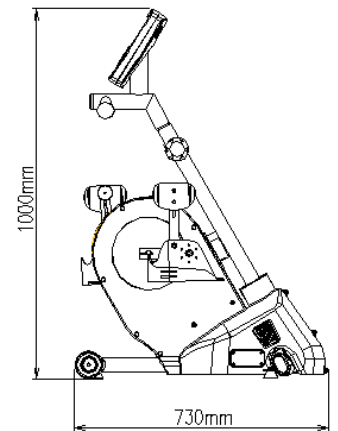
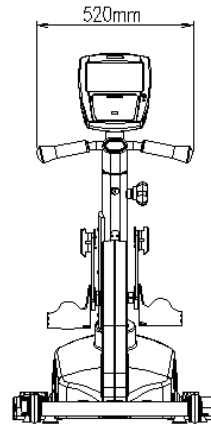
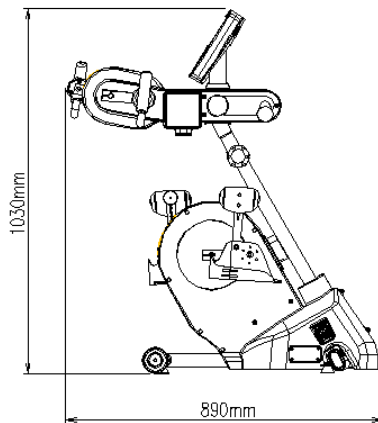
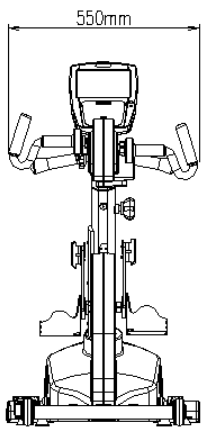

SP-1100P Size : (W) 550mm X (D) 890mm X (H) 1030mm
 Weight : 39kg
 Use Upper Limbs, or Lower Limbs(Pediatric)

SP-2100P Size : (W) 520mm X (D) 730mm X (H) 1000mm
 Weight : 33kg
 Use Only Lower Limbs(Pediatric)

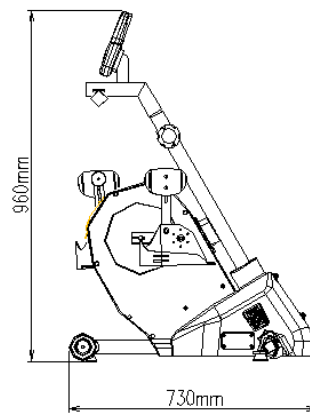
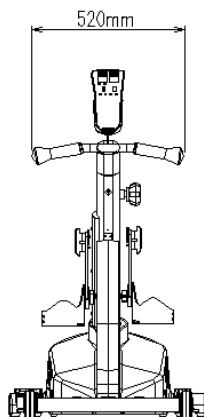
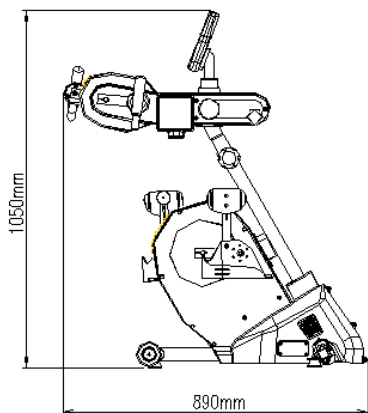
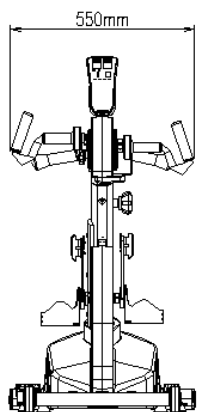

SP-1100PE Size : (W) 550mm X (D) 890mm X (H) 1050mm
 Weight : 39kg
 Use Upper Limbs, or Lower Limbs(Pediatric)

SP-2100PE Size : (W) 520mm X (D) 730mm X (H) 960mm
 Weight : 32kg
 Use Only Lower Limbs(Pediatric)

- Rated Voltage: 110/220V, 50–60Hz,
- Monitor Specification : LCD Monitor–7Inches wide LCD Touch Screen
 LED Monitor–LED indicator display
- Condition for operation: +10 to +40 °C, 30 to 80 % r.h., 70 to 106 kPa
- Condition for transport and storage: –10 to +55 °C, 10 to 95 % r.h., 50 to 106 kPa

2.2 Intended Use

“WARNING–Professional use only under a close supervision by a clinical staff.”

– Reconstruction of the muscles and joints and facilitation of motion for enhanced user recovery..

(1) SP-1100, SP-1100E, SP-1100P, SP-1100PE :

Reconstruction of the upper & lower and joints and facilitation of motion for enhance user recovery.

(2) SP-2100, SP-2100E, SP-2100P, SP-2100PE :

Reconstruction of the lower and joints and facilitation of motion for enhance user recovery.

(3) SP-3100, SP-3100E :

Reconstruction of the upper and joints and facilitation of motion for enhance user recovery.

2.3 Introduction

1. Motor-driven rehabilitation exerciser for elderly people, wheelchair users, apoplexy (paralytic) and remedial exercise.

2. This product is developed for exercise therapy. Rehabilitation is accomplished by providing motorized passive assistance and active resistance when appropriate.

2.4 Product Features

1. Speed, resistance, time, direction of rotation display & segment on screen.
2. Spasm control.
3. Speed and resistance can be adjusted to fit the user's functional capacity.
4. Forward and reverse movement of both upper and lower body pedals.
5. Users can specify the desired amount of exercise time.
6. Biofeedback with the movement.
7. Touch screen monitor.
8. Displays exercise amount by % at active exercise.
9. Easy to use, adjustable pedal positions.

2.4.1 Handle Type

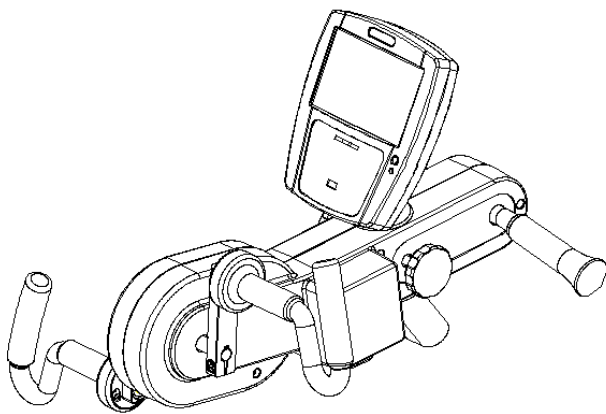

U Shaped Handle
(Standard)

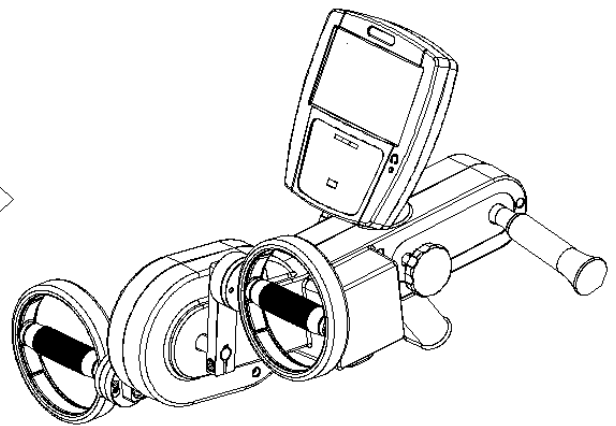
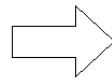

Circular Handle
(Option)

– Except SP series
for Pediatric

3. Name of Components & Installation

3.1 Name of Components

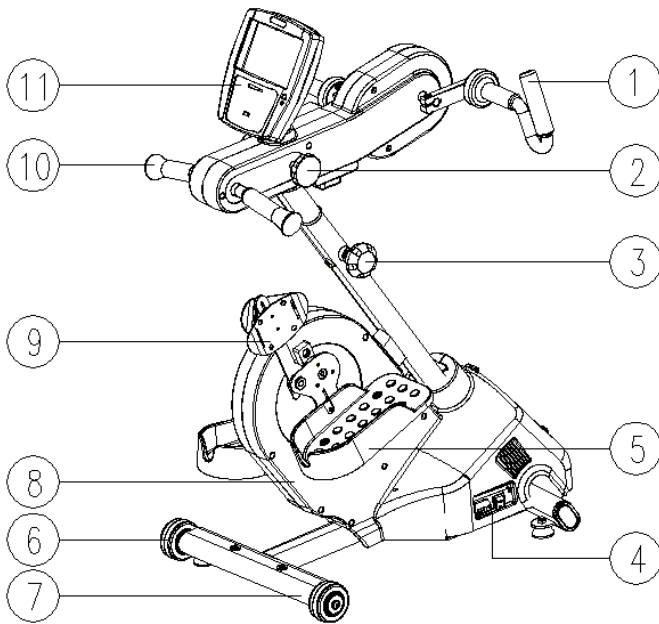

SP-1100
Uses Upper Limbs, or Lower Limbs

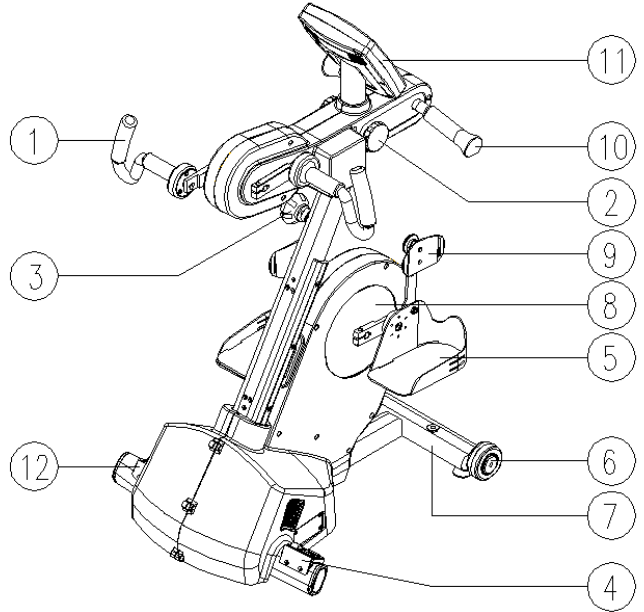

SP-1100P(Pediatric)
Uses Upper Limbs, or Lower Limbs

1. Exercising handles
2. Control knob of handlebar at Upper body
3. Locking screw with knurled knob for adjusting height of Upper body
4. Power switch
5. Pedal
6. Transport wheels
7. Rear Pipe
8. Lower casing
9. Calf support
10. Handlebar
11. Monitor
12. Adjustable switch of Lower body height

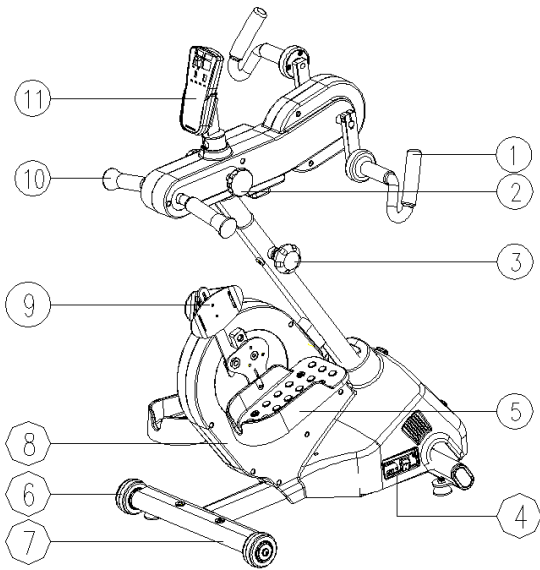

SP-1100E Uses Upper Limbs, or Lower Limbs

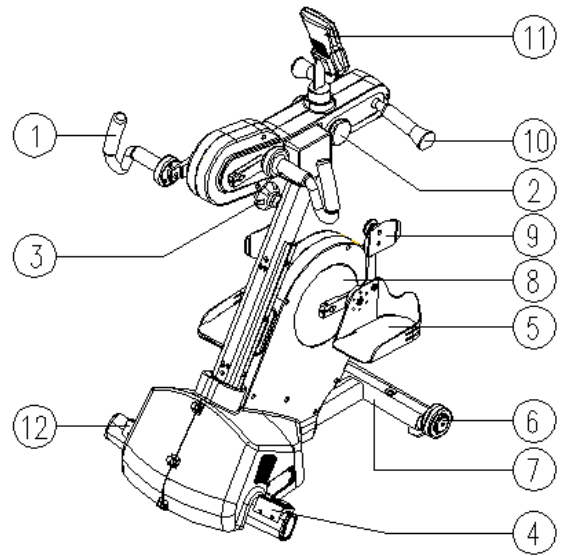

**SP-1100PE(Pediatric)
Uses Upper Limbs, or Lower Limbs**

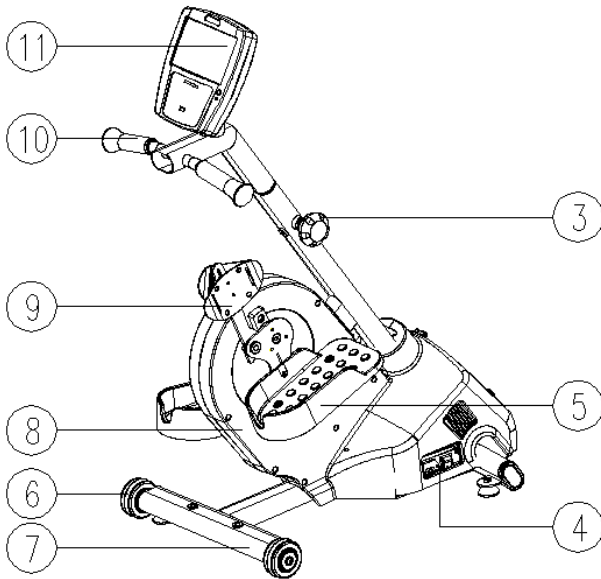

SP-2100 Uses Only Lower Limbs

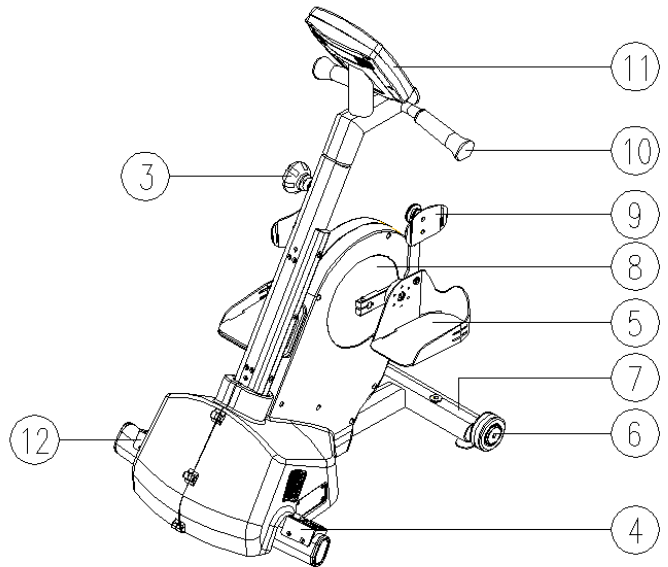

**SP-2100P(Pediatric)
Uses Only Lower Limbs**

1. Exercising handles
2. Control knob of handlebar at Upper body
3. Locking screw with knurled knob for adjusting height of Upper body
4. Power switch
5. Pedal
6. Transport wheels

7. Rear Pipe
8. Lower casing
9. Calf support
10. Handlebar
11. Monitor
12. Adjustable switch of Lower body height

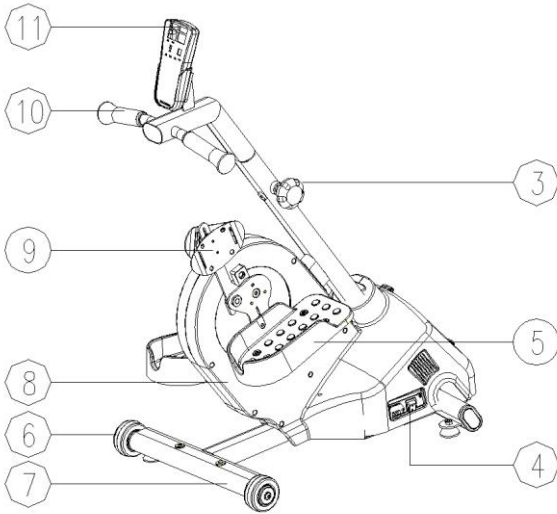

SP-2100E Uses Only Lower Limbs

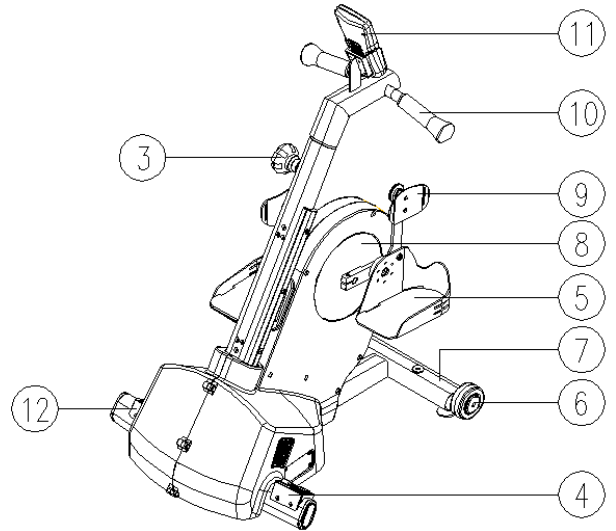

**SP-2100PE(Pediatric)
Uses Only Lower Limbs**

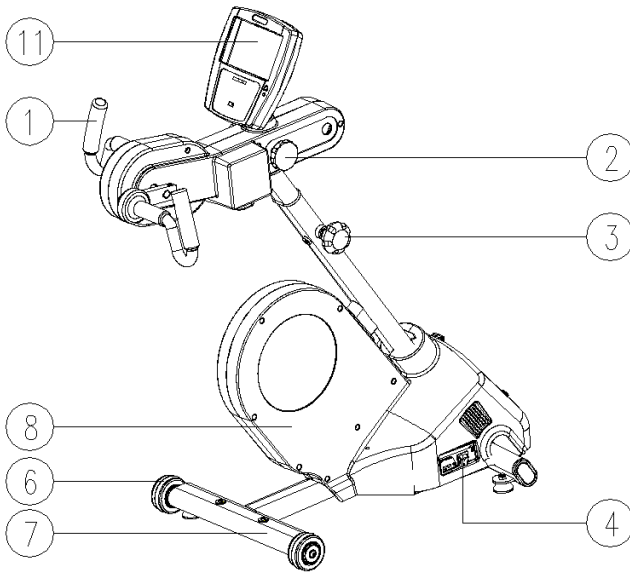

SP-3100 Uses Only Upper Limbs

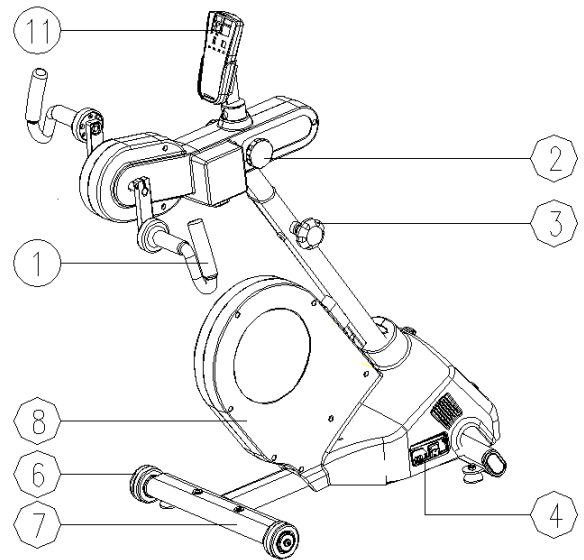

SP-3100E Uses Only Upper Limbs

- 1. Exercising handles
- 2. Control knob of handlebar at Upper body
- 3. Locking screw with knurled knob for adjusting height of Upper body
- 4. Power switch
- 5. Pedal
- 6. Transport wheels

- 7. Rear Pipe
- 8. Lower casing
- 9. Calf support
- 10. Handlebar
- 11. Monitor
- 12. Adjustable switch of Lower body height

3.2 Installation



1. Take care to minimize impact when moving this product.
2. Never use the exerciser with a damaged power cord.
3. This product should be connected to a properly grounded socket.
4. To prevent electrical shock, this product must never be used in moist or humid environments.
5. To avoid risk of electrical shock, this equipment must only be connected to a supply mains and properly grounded.

1. This product should be placed on a horizontally flat floor in accordance with safety and cautions in use.
2. Please keep a minimum of 15 inches side distance between this product and other things.
3. The power has to connect to a properly grounded power outlet.
4. Turn on the main switch.

3.3 Instructions for Using

1. Intended use with supervised only. : Patients must not use without being supervised by an assistant.
2. Do not use for any other purpose.
3. Begin exercise sessions slowly and then increase the level of intensity gradually according to the user's physical capabilities.
4. Leave standing at least one hour at room temperature after transporting or before first use.
5. Children must be constantly supervised when exercising on this product.
6. Never reach into, or attempt to take hold of, moving parts of the exerciser (e.g. cranks, crank length adjuster, footrests, etc.) when it is running.
7. Do not disassemble during use or while plugged in.
8. If this product is damaged, please contact your dealer or authorized service center.

4. Monitor

4.1 LCD Touch Screen Monitor



• Pedal Position Control Button: Pedal and turning knob moves to fixed position.



• Menu Button: Use to return to initial screen after action



• Volume Button: Set volume



• Stop Button



• Start Button

4.2 Segment Monitor

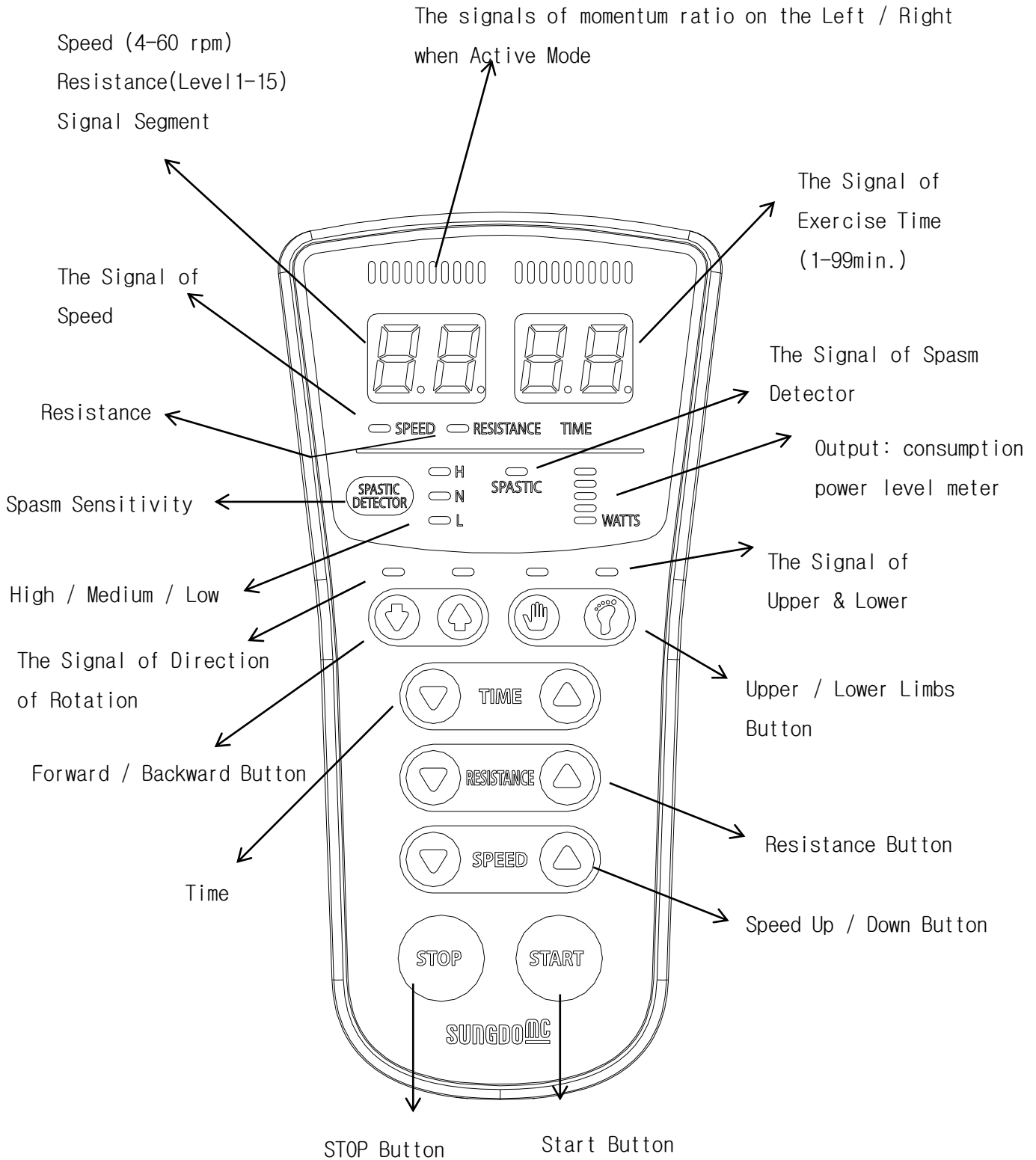

5. Spasm Control

If spasm occurs during exercise, the device will pause and change direction (See Set-up, Page 10) to control and relieve spasm.

A patient who has symptoms of spontaneous muscle spasm while using the unit may cause damage to muscles if the spasm is not controlled, as well as, not being able to realize the desired training effect.

5.1 Spasm Control Sequence

1. Spasm Control acts only in Passive Mode.
2. Start exercise after choosing Spasm Control in Passive Mode (See Set-up, Page 17).
3. If spasm occurs while patient exercises, the number of spasm occurrences is registered on the screen.



CAUTION:

- Patients with predisposition to the occurrence of spasm phenomenon should be supervised throughout exercise.

4. If spasm occurs, unit rotates in desired direction(See Set-up, Page 19) after pausing approximately 3 seconds.
5. If the Spasm Control is initiated three (3) times during a single exercise session, the unit will end the exercise session and report “System Stopped”.
6. If session is ended by the Spasm Control function, turn off main power switch to reset. Turn on again after waiting at least 30 seconds.

5.2 Spasm Control Sequence – Segment Monitor

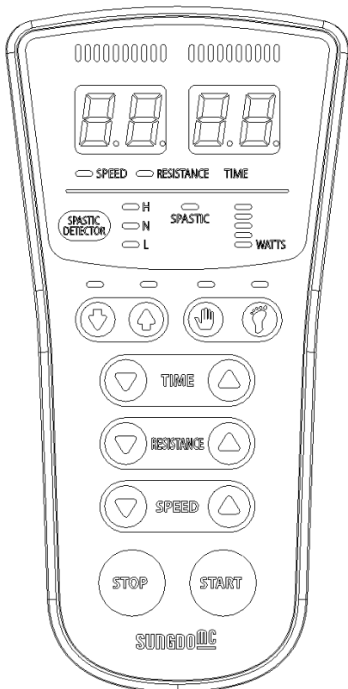

- ① If spasm occurs, the signal of spasm control at the segment monitor shows with the short beep sound.
- ② If spasm occurs 3 times, the short buzz sounds continuously beeping. If session is ended by the Spasm Control function, turn off main power switch to reset. Turn on again after waiting at least 30 seconds.

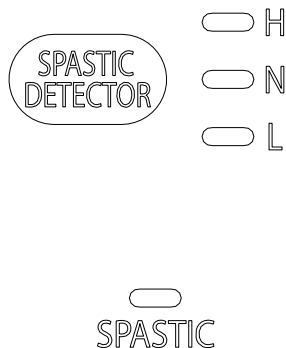

6. How to Use



CAUTION

1. Confirm that the power cable is properly connected prior to each use.
2. When using this unit device for exercise, patient must always maintain a straight, upright position.
3. Patient must use the device with a chair or wheelchair in the proper, comfortable position. Improper positioning can cause discomfort in the knee, hip, elbow, or shoulder.

6.1 Upper Limbs Exercise

1. Twist the two horizontal knobs (counter-clockwise) and rotate the upper body exercise handles into the proper position for upper body exercise. Twist knobs clockwise to lock into position.
2. Use the device while sitting in chair or wheelchair.
3. Adjust height using the height control knob on vertical mast to a proper exercise position. Do NOT let the mast descend uncontrolled into the lowest position – lower with care!
4. Twist knob clockwise until fully tightened to maintain selected vertical height.
5. Do not use the device while standing.
6. Ensure that chair or wheelchair is stable and locked and does not move.
7. Turn on main switch.
8. Begin exercise after completing set-up (See Set-up, Page 17).

6.2 Lower Limbs Exercise

1. Twist the two horizontal knobs (counter-clockwise) and rotate the upper body exercise handles away from the display and user. Twist knobs clockwise to lock into position.
2. Control height using height control knob.
3. Turn on main switch.
4. Use device while sitting on chair or wheelchair.
5. Ensure that chair or wheelchair is stable and locked and does not move.
6. Control pedal position by selecting PEDAL positioning button. User's foot can be easily put into pedal.
7. Fix foot on pedal of device utilizing the Velcro pedal straps.
8. Begin exercise after completing set-up (See Set-up, Page 17).

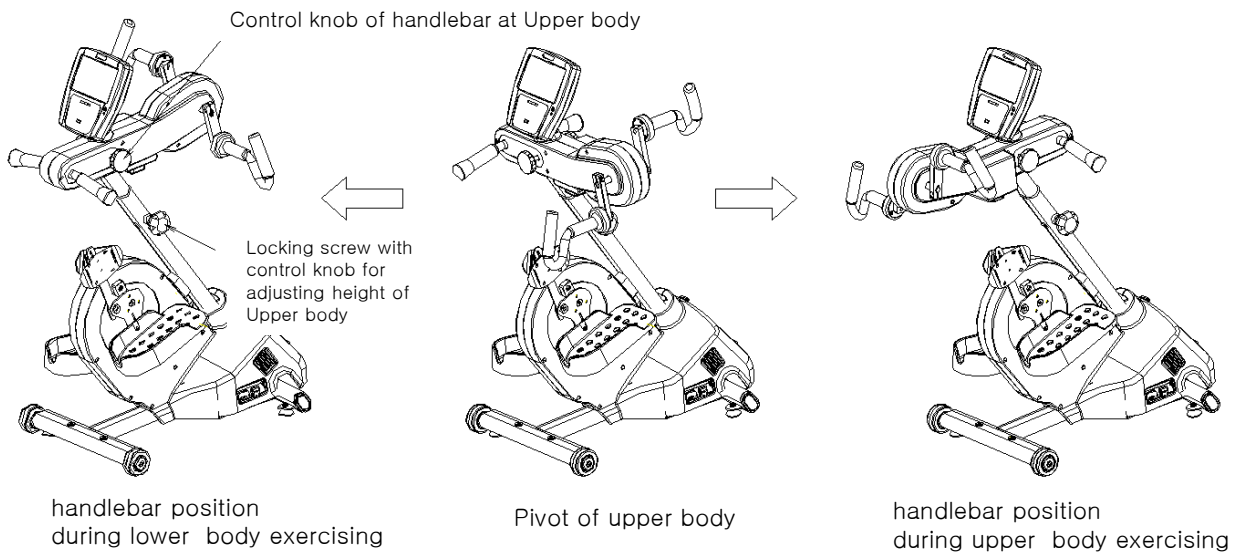

CAUTION

1. Close supervision is necessary when used by, with, or near children, invalids, or physically challenge persons.
2. Confirm that all adjustment knobs and straps are tightened prior to starting exercise.

6.3 Adjusting height with Upper Body

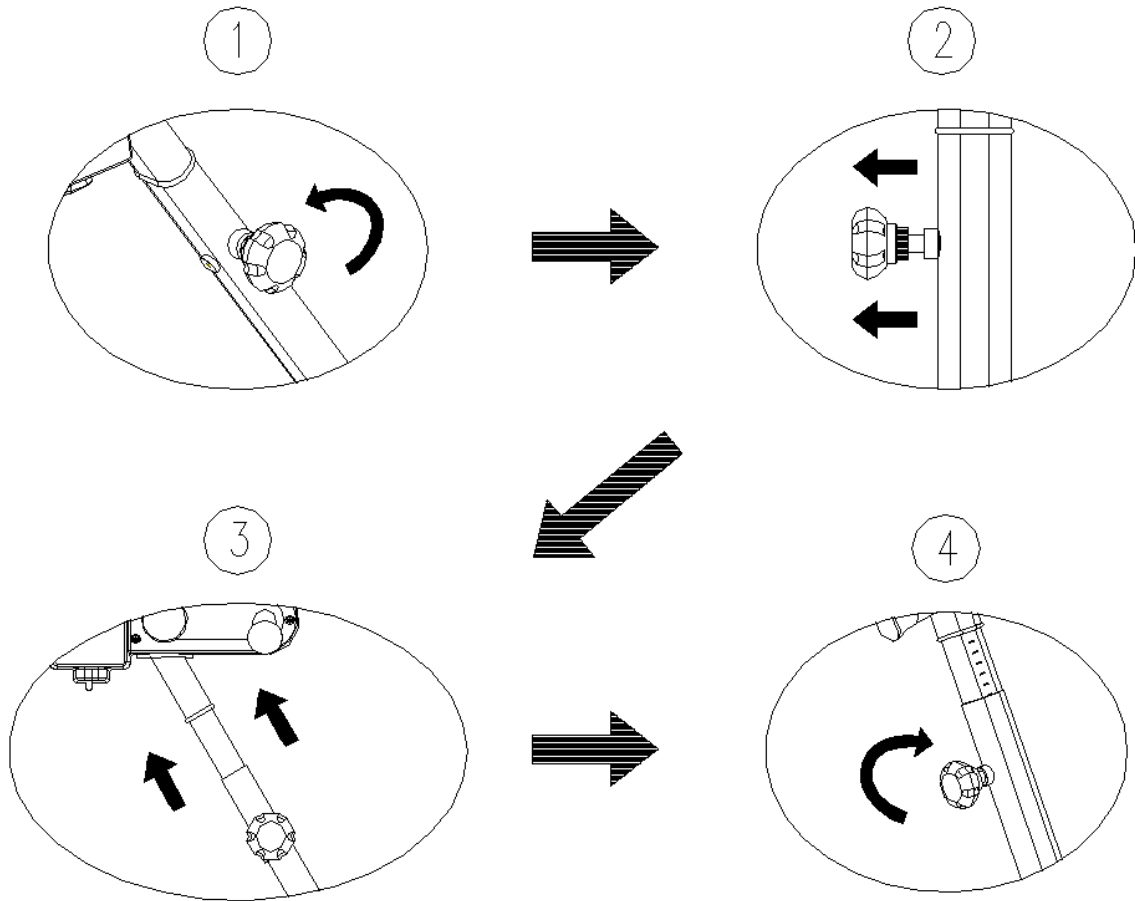

- ① Turn the knob counterclockwise as shown above.
- ② Pull the knob up as shown above.
- ③ Raise the upper body up until it locks into the pin of the knob as shown above.
- ④ If the upper body is fixed, turn the knob clockwise to fix the upper body.

7. PCB Monitor Setting Method(LCD Touch–screen monitor)

7.1 P Mode : Passive Mode

1. Mode which uses force of unit to provide joint movement and muscle rehabilitation exercise for patients who do not move naturally because of arm or leg disability.
2. During P Mode exercise, if user increases the speed through active assistance (pedaling faster than set rpm), the device will transition to Active Mode (A Mode). If user decreases speed to below the set rpm, the device transitions back to P Mode.

7.1.1 Function

Resistance:

- Set resistance value in case exercise is converted from P Mode to A Mode.
- Available to set from 1 to 15 levels (initial setting: level 1).
- Increase/decrease 1 level by pressing +/- button once. Increase to maximum value or reduce to smallest value by pressing continuously. Touch the number for a keypad for direct input.
- Resistance setting can be changed during exercise.
- Set resistance is applied to all speeds.
- Resistance value is applied when exercise is changed to A Mode without being applied in P Mode.

Speed:

- Available to set from 4 to 60 rpm (initial setting: 4 rpm).
- Increase/decrease 2 steps by pressing +/- button once. Increase to maximum value or reduce to smallest value by pressing continuously. Touch the number for a keypad for direct input.
- Speed setting can be changed during exercise.

Time:

- Available to set from 1 to 99 minutes (initial setting: 15 min).
- Increase/decrease 1 minute by pressing +/- button once. Increase to maximum value or reduce to smallest value by pressing continuously. Touch the number for a keypad for direct input.
- Time setting can be changed during exercise.

Direction of Rotation:

- Set direction of rotation of arm and leg exercise.
- Press icon until the desired direction arrow mark lights up.
- Available to select Forward direction or Backward direction.
- Direction can be changed during exercise.

Spasm Control:

- Set Spasm Control availability in case spasm happens while patient exercises (See Spasm Control Set-up, Page 14).
- Spasm Control setting CANNOT be changed during exercise.

Arm and Leg Exercise:

- Select and set exercise region.
- Upper limb and lower limb exercise CANNOT be accomplished at the same time.
- Exercise region (upper limb or lower limb) CANNOT be changed during exercise.

7.1.1 How to Set

1) Select P Exercise mode in initial screen on monitor.

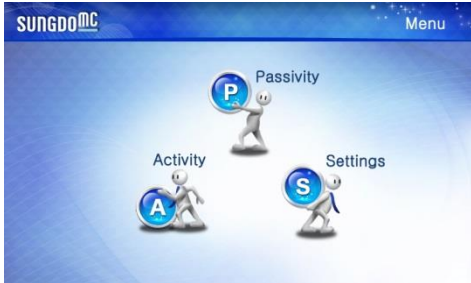

2) Select SPEED button. Set desired speed by pressing + or - button (4-60rpm).



3) Select POWER button. Set desired resistance value by pressing + or - button (Level 1-15).



4) Select DURATION button. Set desired time by pressing + or - button (1-99 min).

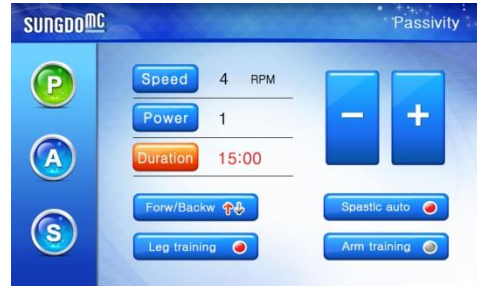

5) Select FORW/BACKW button to set direction of rotation. Pressing the button again changes direction.



6) Select arm training or leg training. Both exercise regions CANNOT be selected at the same time. The circle next to the selected region / button will light up.



7) Press START button on control panel and begin exercise.



8) When the exercise session ends, exercise results will be displayed on monitor.

9) Press MENU button on control panel to return to initial screen.



7.2 S-Program Setting Mode

Allows the user or therapist to define the parameters of an individual exercise program: time, spasm settings and setting suitable sensitivity control systems according to the patient's state.

7.2.1 Function

Spasm Sensitivity:

- It consists of 3 steps of High, Medium, and Low. Sensitivity is set according to patient's spasm degree. During exercise, the spasm control function acts according to set sensitivity.

Spasm Control:

- Select direction of rotation after spasm control according to exercise direction.

↑: After spasm control, regardless of present direction, it rotates unconditionally only to forward direction.

↓: After spasm control, regardless of present direction, it rotates unconditionally only to backward direction.

↕: After spasm control, it rotates to opposite direction of present direction.

Motor Power:

- Used to maintain the amount of power (torque) to correspond to the strength of the upper or lower limbs.
- It consists of 3 steps of Fine, Medium, and Rough.

Exercise Time:

- Set exercise time.
- Control from 1 to 99 minutes (initial setting: 15 min).

7.2.2 How to Set

1) Select P Exercise mode in initial screen on monitor.

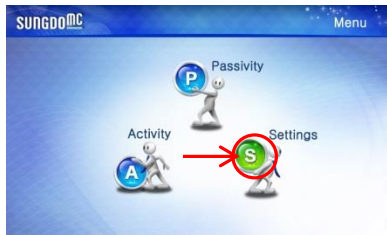

2) Set desired exercise time in next screen by pressing + or - button (Max 99 min).

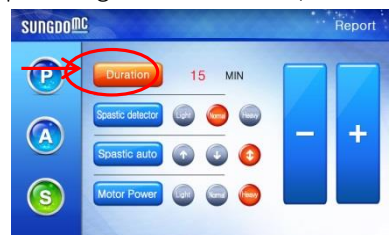

3) Select SPASM DETECTOR button. Set desired sensitivity by pressing High, Medium, or Low.



4) Select SPASTIC AUTO button. Set desired direction by pressing forward, backward, or reverse-direction arrow.



5) Select MOTOR POWER button. Set desired power by pressing High, Medium, or Low.



6) Press MENU button on control panel to store settings. Pressing "P" will also store settings.



7) Press START button on control panel and begin exercise.



8) Press P button on monitor screen to confirm exercise settings. Setting of resistance, speed, and time while exercising is the same with Passive Mode set-up (See Set-up, Page 17).

9) When the exercise session ends, exercise results will be displayed on monitor.



10) Press MENU button on control panel to return to initial screen.



7.3 A Mode: Active Mode

- Active Mode

Mode for exercise using patient's force. Helps increase muscular power by providing resistance against activity.

7.3.1 Function

- ① Resistance: turning load amount during exercise.
- ② Balance(Biofeedback): During exercise, displays force that is imposed by left and right by %

7.3.2 How to Set

- 1) Select A Mode in initial screen on monitor.
- 2) In next screen, set desired resistance by pressing + or - button.

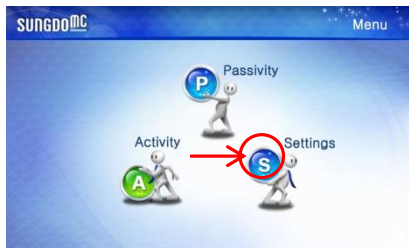

- 3) Press START button on control panel. Start exercise by patient's force.



- 4) Monitor screen displays present speed, exercise time, resistance, and left/right balance (for lower limbs only) during exercise.



- 5) Press STOP button to end exercise session. Exercise results will be displayed on monitor.



- 6) Press MENU button on control panel to return to initial screen.



Short Instruction (SP Series)

Passive Mode

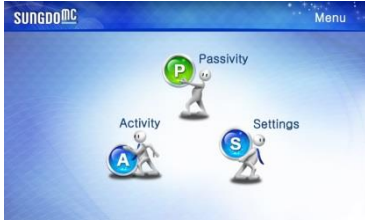

<Main Menu>
Select Passive Mode

Active Mode



<Main Menu>
Select Active Mode



<Adjusting Screen>
Speed (4-60)
Time (1-99Min.)
Select Rotation(F, B)
Select Up.&Lo. Limbs

<Adjusting Screen>
Resistance (1-15)
Select Lower Limb



<Press the Start Button>
Start Training

<Press the Start Button>
Start Training



Training of a Machine



<Press the Stop Button>
Training Result

<Active Mode>
The screen will automatically transfer when the training is started by oneself.

Training of a Machine



<Passive Mode>
The screen will automatically transfer when the training of the lower limbs are stopped.



7.4 Exercise Results

1. Exercise Time(minutes, seconds)
 - Display total exercise time.
2. Exercise Distance (km)
 - Displays total exercise distance.
3. Spasm (number of times)
 - Displays number of spasm control episodes during exercise session.
4. Active Exercise Ratio(%)
 - Displays total active exercise amount.
5. Active Exercise (left) (%) – for lower limb exercise only
 - Displays active exercise grade of left side.
6. Active Exercise (right) (%) – for lower limb exercise only
 - Displays active exercise grade of right side.



8. Monitor Set-up(Segment Monitor)

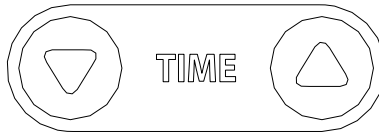

- 1.Speed: Set desired speed by pressing Δ/∇ button.
It can be changed during exercise (4-60rpm)
Set up at start of exercise : 4rpm



- 2.Power: Set desired resistance by pressing Δ/∇ button (Level 1-15).
It can be changed during exercise (level 1-15)
Set up at start of exercise : Level 1

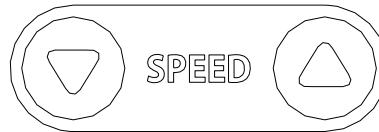

3. Duration: Set desired time by pressing Δ/∇ button.(1-99min.)

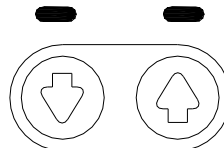

- 4.Select FORW/BACKW button to set direction of rotation.
Pressing the button again changes direction.
When the power switch is 'ON' , \uparrow signal shows on the LED screen.

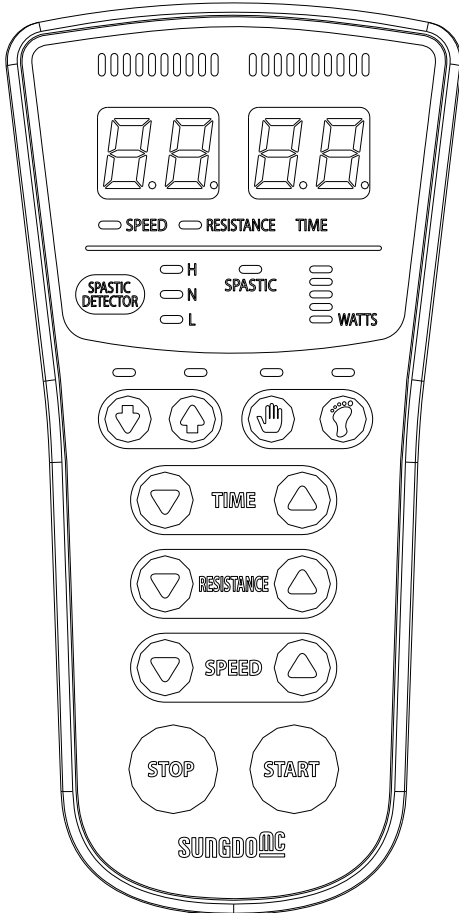

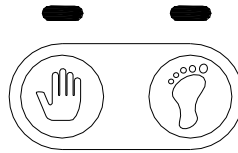

5. Select Lower limbs/ Upper Limbs button: When the power switch is 'ON', Lower Limbs shows on.

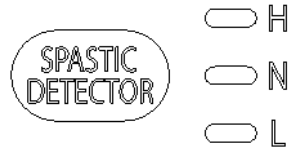
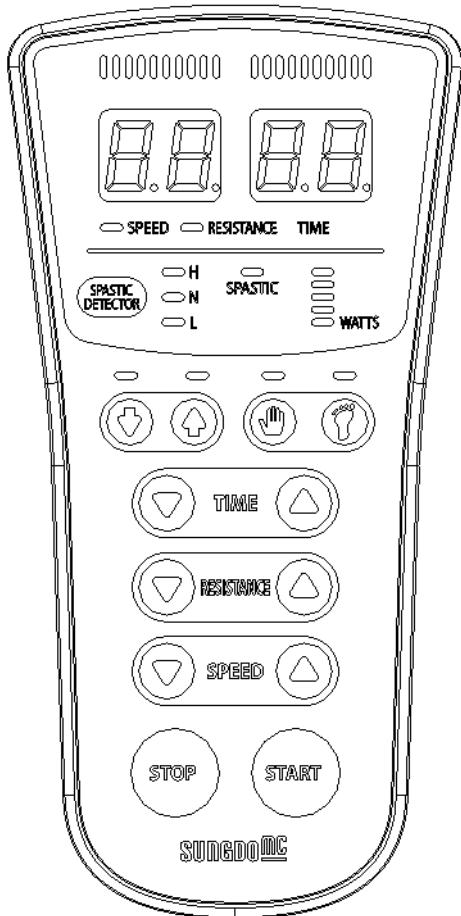

6. SPASTIC AUTOMATICATION button: When the power switch is 'ON', ↑ signal shows on. Spasm Control setting can be changed during exercise.



7. Spasm Control Signal

— When spasm control occurs, the short buzz beeps once with the red lighting signal.

If spasm occurs, unit pauses for approximately 5 seconds, then rotates in the desired direction at a speed 3 rpm lower than before the spasm. If the Spasm is initiated three(3) times during the single exercise session, the it will shows as like this picture  and the unit will end the exercise session with buzz sounds for 20 seconds, then system stopped.

It is available after power is cycled.



8. A Mode: Active Mode

Balance(Biofeedback): During exercise, displays force that is imposed by left and right by LED signals.

There are 10 LED signals on the left/right side, and they are displayed according to the result. Also, it shows as below, during Active exercise.

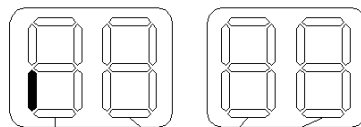

Rotating Track
(Rotate clockwise)

Speed during Active exercise

Note. it will be switch to Active mode, if you exercise (rotate) faster than the set speed (rpm) of Passive mode.

9. Maintenance



Warning:

1. When initiating repair process, turn off main power switch. User may suffer injury from malfunction of the product.
2. Do not repair the device outside of manufacturers recommendations. Manufacturer assumes no responsibility for any alterations or repairs.

9.1 General Items

“Upon request, circuit diagrams, component part lists, descriptions, calibration instructions, or other information will be provided to assist service personnel to repair parts of the equipment that are designated by SungdoMC as repairable by service personnel.”

1. Inspect regularly for any damage and normal operation to use the device safely.
2. Replace worn or damaged parts, particularly high-wear parts, discovered through routine inspection.
3. When checking or replacing consumable parts, be sure to turn off main power switch and remove power cord from the power outlet.
4. Repair and readjustment of product must be done by certified technician or manufacturing company.

9.2 Preventive Maintenance

9.2.1 Daily Inspection Items

1. Always shut off power before checking.
2. Please polish monitor and outside of unit. Use soft cotton material. Do not use abrasive cleaners. Do not use cleaners that contain ammonia or acids.
3. Inspect and remove any foreign substances in and around turning parts (knobs, pedal bearings, etc).
4. Inspect cleanliness of foot pedals and handles.
5. Inspect power plug and all cables for visible damage.
6. Maintain a clean environment around the exercise device.

9.2.2 Weekly Inspection Items

1. Check monitor.
2. Check pedals and handles for proper tightness and eliminate any unusual play.

9.2.3 Main Component Routine Inspection Schedule

I = Inspect C = Clean

Part / Item	Daily	Weekly	Twice a Year
Power plug / cord	I		
Monitor	C	I	
Frame	C		I
Pedal	C	I	
Turning knobs	C	I	
Fixed knobs	C	I	

9.2.4 Prohibited Random Alteration and Reconstruction

1. Product cannot be altered outside of manufacturer's original product specifications.
2. Product alterations or changes are not warranted so that all the losses that might occur are not compensated.
3. The product warranty shall not apply if there is any modification to the product or accessories or if there is a failure to provide maintenance as outlined in the manual.
4. The product warranty does not cover damage or equipment failure resulting from misuse, abuse, or failure to comply with electrical codes.
5. The buyer's remedy for breach of the expressed warranties contained herein shall be limited to the return of the product and accessories and repayment of the original purchase price. Provided, however, at manufacturer selection, it may repair and replace the nonconforming goods or parts.
6. Manufacturer shall not be liable for any incidental or consequential damages.

Note.

The owner of the product is responsible for proper disposal of used or discarded product in compliance with all applicable federal, state and local waste disposal laws and regulations.

Warning –Disposal of waste products

When the crossed-out wheeled bin symbol is attached to a product it means the product is followed By the European Directive 2012/19/EU.

All electrical and electronic products should be disposed of separately from the municipal waste Stream via designated collection facilities appointed by the government or the local authorities.

The correct disposal of your old appliance will help prevent potential negative consequences for the environment and human health.

For more detailed information about disposal of waste products, please contact the local authorities, Waste disposal service or the shop where you purchased the product.

10. Storage and Moving

10.1 Storage Method

1. Keep product in clean, dry environment.
2. Keep product in sealed packing to eliminate dirt, dust, and moisture.
3. Keep separate power supply cord detached while in storage.

10.2 Moving Method

1. Move product using transfer wheels.
2. Requires more than 2 persons to transfer product over steps or up stairs.
3. Do not transfer device with power supply cord attached.
4. Transfer after tightening all adjustment knobs.

11. Product Warranty

1. 1 year limited warranty.
2. Product warranty does not cover damage or equipment failure resulting from mis-use, abuse, or external impact.
3. Product warranty will not apply if there is any modification to the product outside the manufacturers recommendations.

12. Breakdown and Diagnosis

Symptoms	Diagnostic	Solution
No power.	Be sure power cord is properly connected.	Insert correctly in outlet and main body connector.
Pedal not positioned properly.	Press PEDAL position control button	Turn power off and on again to reset. If there is no change, request factory assistance.
Spasm Control function does not work.	Confirm exercise is in Passive Mode. Make sure Spasm Control is selected.	Choose ROUGH spasm control setting in Passive Mode.
Upper limb cranks do not rotate.	Make sure arm exercise is selected.	Choose arm exercise in Passive Mode.
Lower limb cranks do not rotate.	Make sure leg exercise is selected.	Choose leg exercise in Passive Mode.

If you are still experiencing problems please contact your dealer or authorized service center.

13. Product Identification

- Name of item: Physiotherapy Apparatus for Upper and Lower Limbs
- Type: SP-1100, SP-1100E, SP-1100P, SP-1100PE (Physiotherapy Apparatus for Upper and Lower Limbs)
 SP-2100, SP-2100E, SP-2100P, SP-2100PE (Use only Lower Limbs)
 SP-3100, SP-3100E (Use only Upper Limbs)
- Voltage: AC110-220V, 50/60Hz, 96VA
- Speed: 4 - 60rpm
- Power Resistance: Level 1 - 15
- Duration : 1 - 99min
- *Protection against electrical shock: Class I*
- *Protection against harmful ingress of water: Ordinary (IP20)*
- *Methods of sterilization: Not applicable;*
- *Stability of use in an Oxygen Rich Environment: Not suitable;*
- *Mode of operation : Continuous operation.*
- Serial number: Marked separately
- Packing unit: One(1) unit
- Product's Weight: Marked separately
- Date of manufacture: Marked separately
- Stability of use in an Oxygen Rich Environment: Not suitable for use in an Oxygen Rich Environment.
- Manufacturer: BojongMC Co., Ltd.
- Manufacturer's Address: 1dong, 83, Hyeomnyeok-ro, Siheung-si, Gyeonggi-do, 15095, Korea

14. Symbol explanation

~ Alternating current



Type B applied parts (Handle and pedal)



Warning-Disposal of waste products



Serial no.



Combination of Manufacturer and Year of Manufacture



Authorised Representative in the European Community

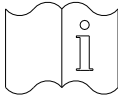

Follow operating instructions



Warning -Crushing hazards from rotating parts